

KIRKBY THERMOSTATIC BATH SHOWER MIXER



| | |
|--------------------|----------------------------|
| Product Code | TBC |
| Operating pressure | 0.2 to 5 |
| Material | Stainless steel, polyester |
| Colour | Chrome |

Description:
The popular style of this Kirby mixer ensures that it is at home in whatever setting it is installed.

- Key features:**
- Suitable for use with unvented supplies, combi boilers, gravity and mains pressure systems
 - Thermal cartridge technology
 - Temperature stability of +/-2°C
 - Fail safe on hot and cold supplies
 - Integrated flow diverter
 - Slide rail
 - WRAS and TMV2 approved

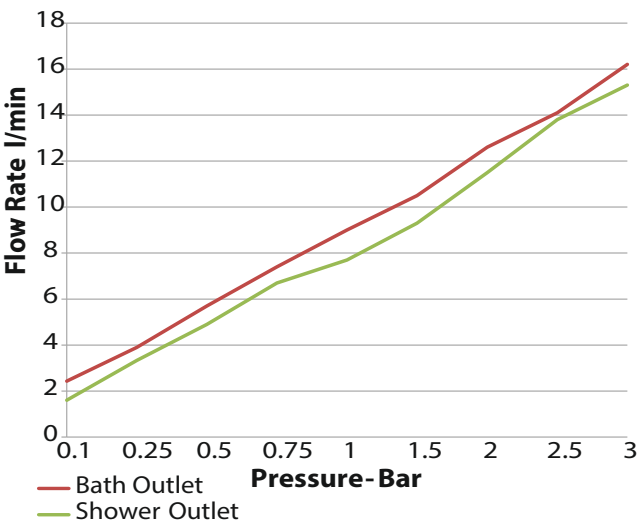
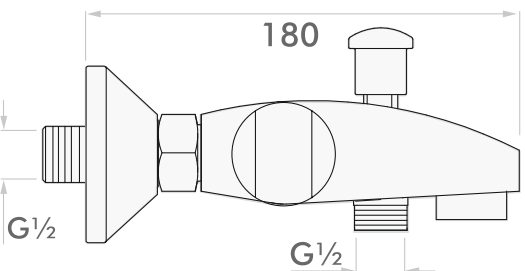
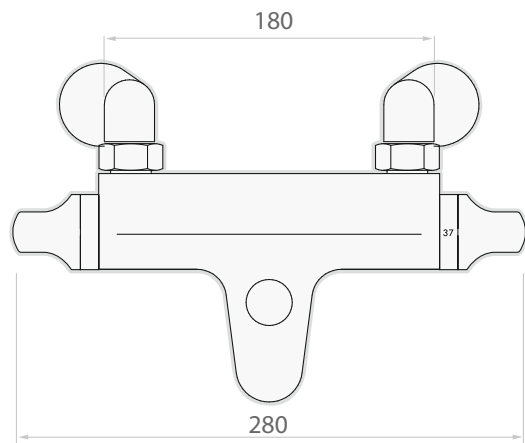

| Technical Specification | |
|---|--|
| Max Inlet Pressure static Min | 5 Bar |
| Inlet Pressure dynamic Max | 0.2 Bar |
| Inlet Temperature Factory | 85°C |
| Pre-set Temperature Inlet | 38°C with max temp stop |
| Connections | G 3/4" F BSP (valve body) G |
| Outlet Connections | 1/2" F BSP |
| Min Temperature to achieve hot or cold failsafe | 15°C |
| System Installation | Unvented, Pressurised, Gravity and Combination Boilers |

All dimensions are approximate and subject to normal ceramic variation. Although every effort is made not to change the above product specification, Lecico reserve the right to do so without prior notification if necessary. Full information on guarantees available upon request.